

● EXPLODED VIEW

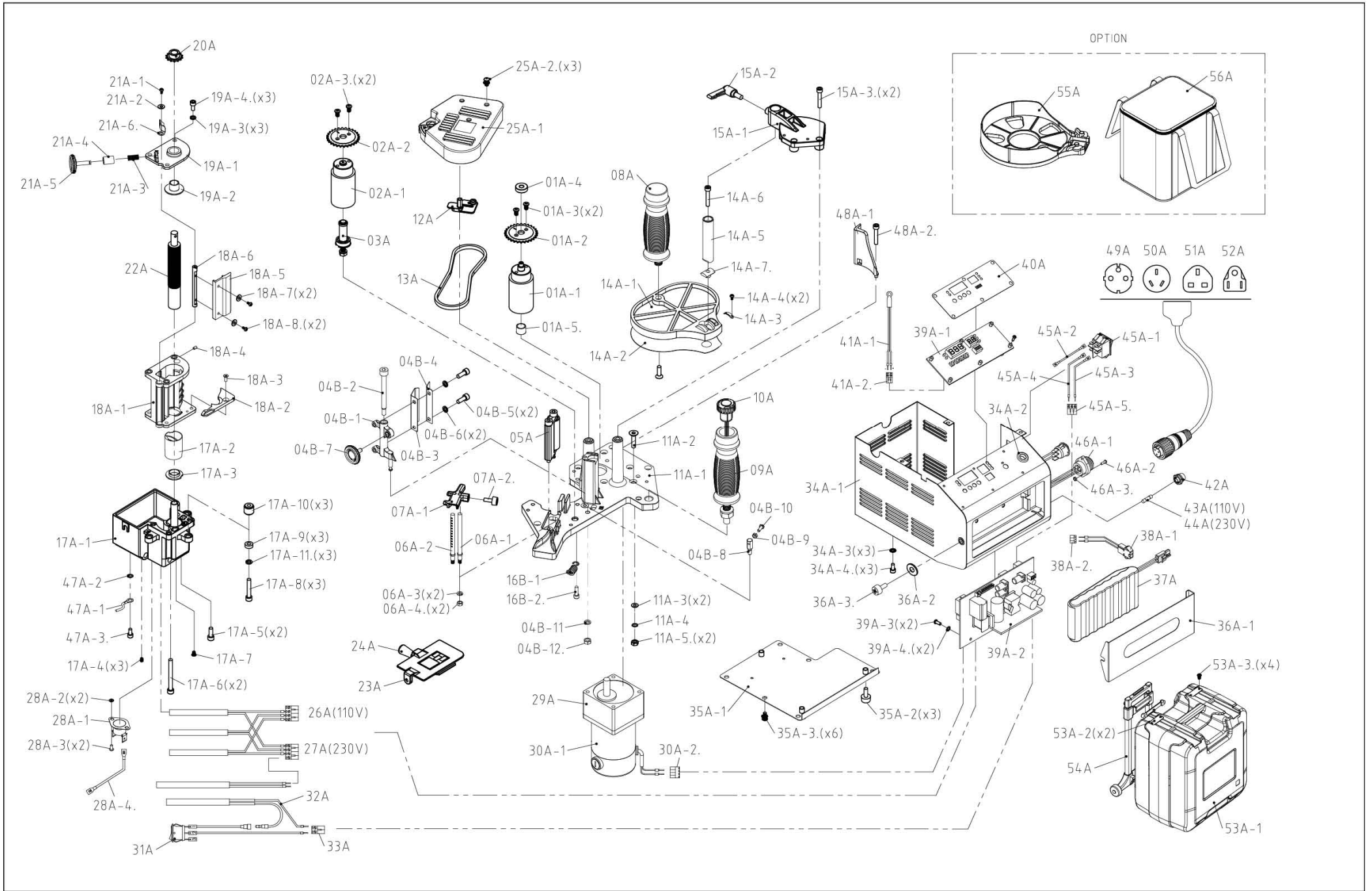

● PARTS LIST

Part No.	Code No.	Description	Q'ty	Part No.	Code No.	Description	Q'ty	Part No.	Code No.	Description	Q'ty
01A	01A	Press Roller Assb.	1	06A	06A	Front Adjustment Shaft Assb.	1	14A-6	G000058	Screw	1
01A-1	U210043	Press Roller	1	06A-1	G320217	Front Adjustment Shaft	1	14A-7.	A600007	Slide	1
01A-2	A500003	Sprocket	1	06A-2	G320292	Front Adjustment Shaft	1	15A	15A	Sliding Plate Support Assb	1
01A-3	S300610	Cap Screw	2	06A-3	N030005	Spring Washer 5mm	2	15A-1	C020076	Sliding Plate Support	1
01A-4	B08608-ZZ	Bearing	1	06A-4.	N11005R	Nut M5	2	15A-2	T060008	Pull Handle	1
01A-5.	R151012	One-way Bearing	1	07A	07A	Front Adjustment Support Assb.	1	15A-3.	S900625	Cap Screw	2
02A	02A	Feed Roller Assb.	1	07A-1	U010112	Front Adjustment Support	1	16B	16B	Spring Assb.	1
02A-1	C020072	Feed Roller	1	07A-2.	U010039	Screw	1	16B-1	N910005	Spring	1
02A-2	A500003	Sprocket	1	08A	08A	Hand Grip Assb.	1	16B-2.	S900516	Cap Screw	1
02A-3.	S300610	Cap Screw	2	09A	09A	Joystick Assb.	1	17A	17A	Glue Pot Assb.	1
03A	03A	Feed Roller Shaft Assb.	1	10A	10A	Joystick Switch	1	17A-1	C020073	Glue Pot	1
04B	04B	Pressing Plate Assembly	1	11A	11A	Main Frame Assb.	1	17A-2	C020083	Spiral Tube	1
04B-1	C020077	Thickness adjusting base	1	11A-1	C020070	Main Frame	1	17A-3	A510002	Bottom Sintered Bushing	1
04B-2	G000057	Thickness adjusting shaft	1	11A-2	S200520N	Cap Screw	1	17A-4	S100406	Screw	3
04B-3	G150036	Rear pressing plate	1	11A-3	N010510	Lock Washer	2	17A-5	S900616	Cap Screw	2
04B-4	G150038	Pressing plate	1	11A-4	N050005	Zinc Lock Washer	1	17A-6	S900680	Cap Screw	2
04B-5	S900612	Cap Screw M 6 X 12 L	2	11A-5.	N11005C	N11005C	2	17A-7	S300405	Cap Screw	1
04B-6	N030006	Spring Washer 6mm	2	12A	12A	Chain Adjusting Chip Assb.	1	17A-8	S900632	Cap Screw	3
04B-7	U010288	KNOB M6x14L	1	13A	K320072	Chain	1	17A-9	U010094	Bakelite Washer	3
04B-8	G080017	Positioning screw M6x12L	1	14A	14A	Sliding Plate Assb.	1	17A-10	U010292	Insulation Spacer	3
04B-9	N11004R	Nut M4	1	14A-1	C020079	Sliding Plate	1	17A-11.	N030006	Spring Washer	3
04B-10	G000031	Adjusting screw -M4x12L	1	14A-2	U010165	PVC Plate	1	18A	18A	Gluing Base Assb.	1
04B-11	N030006	Spring Washer M6	1	14A-3	P200070	Scale Chip	1	18A-1	C020111	Gluing Base	1
04B-12.	N11006R	Nut M6	1	14A-4	S500304	Cap Screw	2	18A-2	C020112	Metal Plate	1
05A	05A	Roller Support Assb.	1	14A-5	G320219	Elevating Rod	1	18A-3	S200408	Cap Screw	1

Part No.	Code No.	Description	Q'ty	Part No.	Code No.	Description	Q'ty	Part No.	Code No.	Description	Q'ty
18A-4	S100406	Screw	1	28A	28A	Temperature Control Switch Assb.	1	38A	38A	Connector set	1
18A-5	C020081	Main Scraper Plate	1	28A-1	J380006	Temperature Control Switch	1	38A-1	J910098	Connector	1
18A-6	G320218	Scraper Support Pin	1	28A-2	N010306	Washer	2	38A-2.	J530207	Euro Terminal block P3.5x3H	1
18A-7	N010412	Zinc Flat Washer	2	28A-3	S500306	Cap Screw	2	39A	39A	Panel Assb.100V-240V	1
18A-8.	S300408	Cap Screw	2	28A-4.	J910096	Heat Resistant Wire	1	39A-1	J011226	Panel 100V-240V	1
19A	19A	Metal Cover Assb	1	29A	K017362M	Gear Reduction 3GN36K	1	39A-2	J011227	Power Plate 100~240V	1
19A-1	C020113	Metal Cover	1	30A	30A	Motor Assb.	1	39A-3	S800412	Cap Screw	2
19A-2	A510001	Top spacer	1	30A-1	L603201	DC Motor	1	39A-4.	N050004	Lock Washer	2
19A-3	N030006	Spring Washer	3	30A-2.	J530205	Euro Terminal block P3.5x4H	1	40A	P360008	Control Panel -DR500	1
19A-4.	S900612	Cap Screw M 6 X 12 L	3	31A	J910100A	Switch wiring set	1	41A	41A	Thermocouple Assb.	1
20A	20A	Sprocket Assb.	1	32A	J370036	Heating Unit 24VX100W	1	41A-1	J910090	Thermocouple	1
21A	21A	Scraper Adjustment Assb.	1	33A	J530211	Euro Terminal block	1	41A-2.	J530204	Euro Terminal block P3.5x2H	1
21A-1	S300506	Cap Screw	1	34A	33A	Housing Assb.	1	42A	J550010	Fuse Bracket CUL/CE (red/10A)	1
21A-2	N040005	Lock Washer	1	34A-1	G110308	Housing	1	43A	J340009	Fuse-10A(110-115V)	1
21A-3	N930016	Spring	1	34A-2	J510003	Power Cord Holder	1	44A	J340006	Fuse-6A(200-240V)	1
21A-4	U010241	Washer	1	34A-3	N050005	Zinc Sprocket Washer	3	45A	45A	Power Switch Assb.	1
21A-5	U010266	Knob	1	34A-4.	S900510	Cap Screw	3	45A-1	J110014	Power Switch	1
21A-6.	G810004	Scraper Support Pin	1	35A	35A	Base Cover	1	45A-2	J910044	Heat Resistant Wire.-white	1
22A	G320281	Gluing Shaft	1	35A-1	G110161	Base Cover	1	45A-3	J910097	Heat Resistant Wire-red.	1
23A	C020075	Glue Pot Cover Assb.	1	35A-2	U010039	Screw -M6x18L	3	45A-4	J910088	Heat Resistant Wire-red.	1
24A	U010164	Lock Handle	1	35A-3.	S330512	Cover Screw M5x12	6	45A-5.	J530202	Euro Terminal block P5.0x3H	1
25A	25A	Top Ventilated Cover Assb.	1	36A	36A	Battery Cover Kit	1	46A	46A	Electric outlet set	1
25A-1	U010168	Top Ventilated Cover	1	36A-1	G110319	Battery Cover	1	46A-1	J530108	Male electric outlet	1
25A-2.	S330512	Cover Screw	3	36A-2	N015707	Washer	1	46A-2	S500310	Screw M3 X 10L	2
26A	26A	Heating Unit-110V	1	36A-3.	U010294	Screw M6x12	1	46A-3.	N11003R	Nut M3	2
27A	27A	Heating Unit-230V	1	37A	J810001A	Battery Set	1	47A	47A	Grounding Wire Assb.	1

● 接線圖

